

IMR01N11-E4

Thank you for purchasing this RKC product. In order to achieve maximum performance and ensure proper operation of your new instrument, carefully read all the instructions in this manual. Please place this manual in a convenient location for easy reference.

WARNING

- An external protection device must be installed if failure of this instrument could result in damage to the instrument, equipment or injury to personnel.
- All wiring must be completed before power is turned on to prevent electric shock, fire or damage to instrument and equipment.
- This instrument must be used in accordance with the specifications to prevent fire or damage to instrument and equipment.
- This instrument is not intended for use in locations subject to flammable or explosive gases.
- Do not touch high-voltage connections such as power supply terminals, etc. to avoid electric shock.
- RKC is not responsible if this instrument is repaired, modified or disassembled by other than factory-approved personnel. Malfunction can occur and warranty is void under these conditions.

CAUTION

- This product is intended for use with industrial machines, test and measuring equipment. (It is not designed for use with medical equipment and nuclear energy.)
- This is a Class A instrument. In a domestic environment, this instrument may cause radio interference, in which case the user may be required to take adequate measures.
- This instrument is protected from electric shock by reinforced insulation. Provide reinforced insulation between the wire for the input signal and the wires for instrument power supply, source of power and loads.
- Be sure to provide an appropriate surge control circuit respectively for the following:
 - If input/output or signal lines within the building are longer than 30 meters.
 - If input/output or signal lines leave the building, regardless the length.
- This instrument is designed for installation in an enclosed instrumentation panel. All high-voltage connections such as power supply terminals must be enclosed in the instrumentation panel to avoid electric shock by operating personnel.
- All precautions described in this manual should be taken to avoid damage to the instrument or equipment.
- All wiring must be in accordance with local codes and regulations.
- To prevent instrument damage or failure, protect the power line and the input/output lines from high currents with a protection device such as fuse, circuit breaker, etc.
- Prevent metal fragments or lead wire scraps from falling inside instrument case to avoid electric shock, fire or malfunction.
- Tighten each terminal screw to the specified torque found in the manual to avoid electric shock, fire or malfunction.
- For proper operation of this instrument, provide adequate ventilation for heat dispensation.
- Do not connect wires to unused terminals as this will interfere with proper operation of the instrument.
- Turn off the power supply before cleaning the instrument.
- Do not use a volatile solvent such as paint thinner to clean the instrument. Deformation or discoloration will occur. Use a soft, dry cloth to remove stains from the instrument.
- To avoid damage to instrument display, do not rub with an abrasive material or push front panel with a hard object.

NOTICE

- This manual assumes that the reader has a fundamental knowledge of the principles of electricity, process control, computer technology and communications.
- The figures, diagrams and numeric values used in this manual are only for purpose of illustration.
- RKC is not responsible for any damage or injury that is caused as a result of using this instrument, instrument failure or indirect damage.
- RKC is not responsible for any damage and/or injury resulting from the use of instruments made by imitating this instrument.
- Periodic maintenance is required for safe and proper operation of this instrument. Some components have a limited service life, or characteristics that change over time.
- Every effort has been made to ensure accuracy of all information contained herein. RKC makes no warranty expressed or implied, with respect to the accuracy of the information. The information in this manual is subject to change without prior notice.
- No portion of this document may be reprinted, modified, copied, transmitted, digitized, stored, processed or retrieved through any mechanical, electronic, optical or other means without prior written approval from RKC.

Accessories

Mounting brackets: 2 [HA430], 4 [HA930]
Instruction Manual: 1 (IMR01N11-E4)

1. MOUNTING

WARNING

To prevent electric shock or instrument failure, always turn off the power before mounting or removing the instrument.

Mounting Cautions

- (1) This instrument is intended to be used under the following environmental conditions. (IEC61010-1) [OVERVOLTAGE CATEGORY II, POLLUTION DEGREE 2]
- (2) Use this instrument within the following environment conditions.
 - Allowable ambient temperature: -10 to +50 °C
 - Allowable ambient humidity: 5 to 95 %RH (Absolute humidity: MAX. W. C 29.3 g/m³ dry air at 101.3 kPa)
 - Installation environment conditions: Indoor use, Altitude up to 2000 m
- (3) Avoid the following conditions when selecting the mounting location:
 - Rapid changes in ambient temperature which may cause condensation.
 - Corrosive or inflammable gases.
 - Direct vibration or shock to the mainframe.
 - Water, oil, chemicals, vapor or steam splashes.
 - Excessive dust, salt or iron particles.
 - Excessive induction noise, static electricity, magnetic fields or noise.
 - Direct air flow from an air conditioner.
 - Exposure to direct sunlight.
 - Excessive heat accumulation.
- (4) If this instrument is permanently connected to equipment, it is important to include a switch or circuit-breaker into the installation. This should be in close proximity to the equipment and within easy reach of the operator. It should be marked as the disconnecting device for the equipment.

Dimensions

● HA430

(Unit: mm)

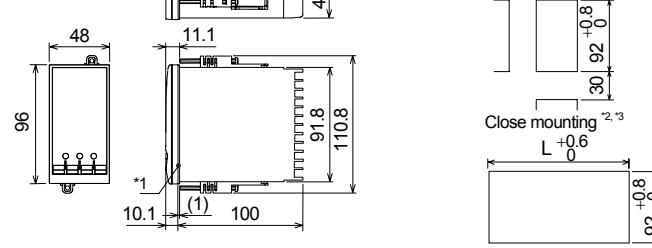

● HA930

(Unit: mm)

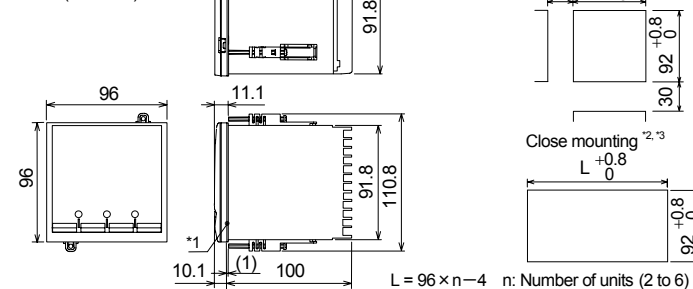

*1 Rubber

*2 If the HA430s or HA930s have waterproof/dustproof options, protection will be compromised and not meet IP65 by close mounting.

*3 When controllers are closely mounted, ambient temperature must not exceed 50 °C.

For mounting of the HA430 or HA930, panel thickness must be between 1 to 10 mm. When mounting multiple HA430s or HA930s close together, the panel strength should be checked to ensure proper support.

Mounting Procedures

1. Prepare the panel cutout as specified in ■ Dimensions.
2. Insert the instrument through the panel cutout.
3. Insert the mounting bracket into the mounting groove of the instrument. (Fig. 1)
4. Pull till click sounds to the direction shown by the arrow. (Fig. 2)
5. Tighten up the screw. (Fig. 3)
6. The other mounting bracket should be installed the same way described in 3. to 5.

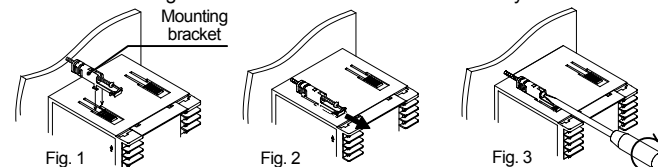

HA930 is used in the above figures for explanation, but the same mounting procedures also apply to HA430.

When using the mounting screws, only turn one full revolution after the screw touches the panel.

- When the instrument is mounted, always secure with two mounting brackets so that upper and lower mounting brackets are positioned diagonally.
- The waterproof/dustproof option on the front of the instrument conforms to IP65 when mounted on the panel. For effective waterproof/dustproof, the gasket must be securely placed between instrument and panel without any gap. If gasket is damaged, please contact RKC sales office or the agent.

2. WIRING

WARNING

To prevent electric shock or instrument failure, do not turn on the power until all the wiring is completed. Make sure that the wiring has been properly made before applying power to the instrument.

Wiring Cautions

- For thermocouple input, use the appropriate compensation wire.
 - For RTD input, use low resistance lead wire with no difference in resistance between the three lead wires.
 - Use a special shielded cable for connection with the pressure sensor. When using our CZ-100P or CZ-200P: The rated output (mV/V) of pressure sensor is when the cable is at a length of 5 m. If the cable is extended, correct the rated output using the following equation. Set the correction value thus calculated to "Gain setting." For the Gain setting screen, refer to Operation Manual (IMR01N12-EQ).
- Correction equation: $e1 = e2(1 + K \cdot L) \rightarrow e2 = \frac{e1}{1 + K \cdot L}$

e1: Rated output in standard-cable length 5 m (mV/V is described on the nameplate of the sensor)
e2: Rated output after extension
K: Correction factor* $1.96 \times 10^{-4}/m$ [Non-explosionproof specification type], $1.40 \times 10^{-4}/m$ [Explosionproof specification type]
* When using 0.5 mm² × 4-core shielded cable (standard-cable) or equal.
L: Extended cable length (m)
- To avoid noise induction, keep input signal wire away from instrument power line, load lines and power lines of other electric equipment.
 - If there is electrical noise in the vicinity of the instrument that could affect operation, use a noise filter.
 - Shorten the distance between the twisted power supply wire pitches to achieve the most effective noise reduction.

- Always install the noise filter on a grounded panel. Minimize the wiring distance between the noise filter output and the instrument power supply terminals to achieve the most effective noise reduction.
- Do not connect fuses or switches to the noise filter output wiring as this will reduce the effectiveness of the noise filter.
- About five seconds are required as preparation time for contact output every time the instrument is turned on. Use a delay relay when the output line is used for an external interlock circuit.
- Power supply wiring must be twisted and have a low voltage drop.
- This instrument is not furnished with a power supply switch or fuse. Therefore, if a fuse or power supply switch is required, install close to the instrument. Recommended fuse rating: Rated voltage 250 V, Rated current 1 A Fuse type: Time-lag fuse
- For an instrument with 24 V power supply, supply power from a SELV circuit.
- A suitable power supply should be considered in the end-use equipment. The power supply must be in compliance with a limited-energy circuits (maximum available current of 8 A).
- Use the solderless terminal appropriate to the screw size. Screw size: M3×6 (With 5.8×8 square washer) Recommended tightening torque: 0.4 N·m (4 kgf·cm)
- Make sure that the any wiring such as solderless terminal is not in contact with the adjoining terminals.

Terminal Configuration (All the terminal configuration of HA430 and HA930 is the same.)

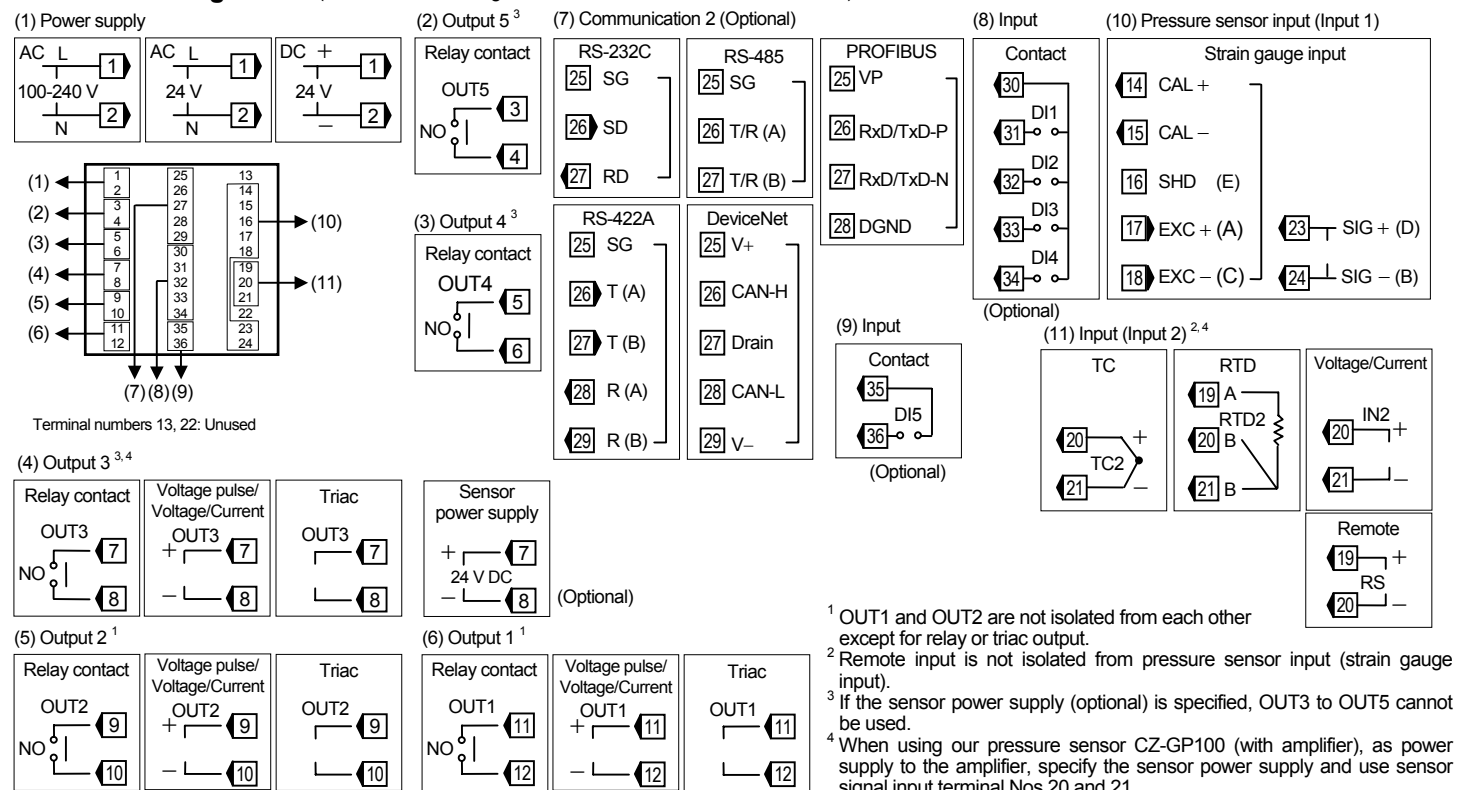

¹ OUT1 and OUT2 are not isolated from each other except for relay or triac output.

² Remote input is not isolated from pressure sensor input (strain gauge input).

³ If the sensor power supply (optional) is specified, OUT3 to OUT5 cannot be used.

⁴ When using our pressure sensor CZ-GP100 (with amplifier), as power supply to the amplifier, specify the sensor power supply and use sensor signal input terminal Nos.20 and 21.

Specifications

Power supply voltage:

90 to 264 V AC [Power supply voltage range], 50/60 Hz (Rating: 100 to 240 V AC)
21.6 to 26.4 V AC [Power supply voltage range], 50/60 Hz (Rating: 24 V AC)
21.6 to 26.4 V DC [Power supply voltage range] (Rating: 24 V DC)

Power consumption:

HA430:	16.5 VA max. (at 100 V AC)	22.5 VA max. (at 240 V AC)
	15.0 VA max. (at 24 V AC)	430 mA max. (at 24 V DC)
HA930:	17.5 VA max. (at 100 V AC)	24.0 VA max. (at 240 V AC)
	16.0 VA max. (at 24 V AC)	470 mA max. (at 24 V DC)

Input 1:

Pressure sensor input
Relevant sensor: Strain gauge type pressure sensor

Input 2:

TC input, RTD input, Voltage input, Current input

Option input:

Remote input (Not isolation type), Event input

Power supply for strain gauge type of pressure sensor:

Rated voltage (EXC):	8 V DC ±3 %
Temperature drift:	80 ppm/°C
Rated current:	30 mA max.

Sensor power supply (optional):

Rated voltage:	24 V DC ±5 %
Rated current:	24 mA max.

Output 1 to 3 (OUT1 to OUT3):

Relay contact output: 250 V AC, 3A (Resistive load), 1a contact
Electrical life 300,000 times or more (Rated load)

Voltage pulse output: 0/12 V DC (Load resistance 600 Ω or more)

Current output: 0 to 20 mA DC, 4 to 20 mA DC

(Load resistance 600 Ω or less)

Voltage output: 0 to 5 V DC, 1 to 5 V DC, 0 to 10 V DC

(Load resistance 1 kΩ or more)

Rated current 0.4 A

Triac output:

Output 4 (OUT4), Output 5 (OUT5):

Relay contact output: 250 V AC, 1 A (Resistive load), 1a contact
Electrical life 300,000 times or more (Rated load)

Control method:

Brilliant PID control
(Direct action or Reverse action is available)

Allowable ambient temperature:

-10 to +50 °C

Allowable ambient humidity:

5 to 95 %RH

Operating environment:

There should be neither corrosive gases nor much dust.

Weight:

HA430: Approx. 360 g HA930: Approx. 460 g

3. PARTS DESCRIPTION

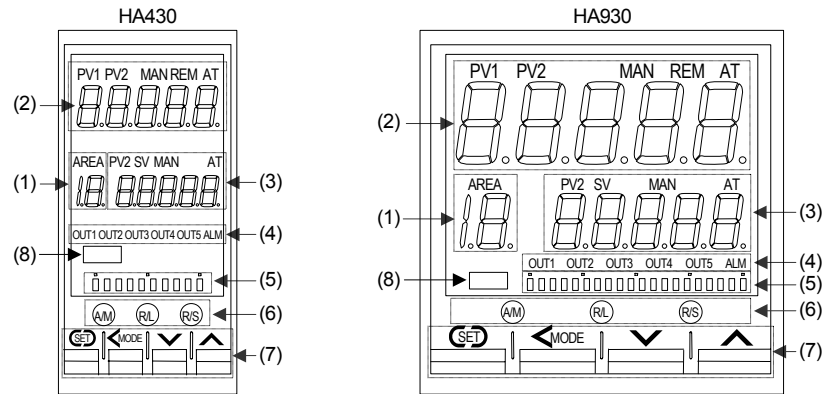

(1) Area display

Area (AREA) lamp	[Green]	Lights when memory area number is displayed.
Memory area display		Displays memory area number (1 to 16).

(2) Upper display

Measured value 1 (PV1) lamp	[Green]	Lights when measured value 1 is displayed on the PV1/PV2 display unit.
Measured value 2 (PV2) lamp *	[Green]	Lights when measured value 2 is displayed on the PV1/PV2 display unit.
Manual (MAN) mode lamp	[Green]	Lights when operated in manual mode.
Remote (REM) mode lamp	[Green]	Lights when remote setting function is activated.
Autotuning (AT) lamp	[Green]	Flashes when autotuning is activated. (After autotuning is completed: AT lamp will go out)
Measured value (PV1/PV2) display		Displays PV1, PV2 or various parameter symbols.

* This lamp is activated only with 2-input controller.

(3) Lower display

Measured value 2 (PV2) lamp *	[Green]	Lights when measured value 2 is displayed on the SV display unit.
Set value (SV) lamp	[Green]	Lights when set value (SV) is displayed on the SV display unit.
Manual (MAN) mode lamp *	[Green]	Lights when operated in manual mode.
Autotuning (AT) lamp *	[Green]	Flashes when autotuning is activated. (After autotuning is completed: AT lamp will become OFF)
Set value (SV) display		Displays SV, PV2 or various parameter set values.

* This lamp is activated only with 2-input controller.

(4) Output/Alarm lamp

Output (OUT1 to OUT5) lamp	[Green]	Lights when the output corresponding to each lamp is ON.
Alarm (ALM) lamp	[Red]	Lights when alarm (Event function) is turned on. The type of alarm which is on can be checked on the event monitor display.

(5) Bar graph display *

One of the displays shown in the table below can be selected for the bar-graph.

Manipulated output value (MV) display	Displays the manipulated output value (MV). When manipulated output value (MV) is at 0 % or less, the left-end dot of the bar-graph flashes. When MV exceeds 100 %, the right-end dot flashes. [Example]
Deviation display	Displays the deviation between the measured value (PV) and the set value (SV). When the Deviation display is selected, the dots at both ends of bar-graph light. [Example]
Measured value display	Displays the measured value (PV). Scaling is available within the input range.
Set value display	Displays the set value (SV). Scaling is available within the input range.

* The number of dots: 10 dots (HA430), 20 dots (HA930)

(6) Direct key

AM Auto/Manual transfer key	Switching the Auto/Manual control mode between Auto (PI control) mode and Manual mode.
RL Remote/Local transfer key	Switching the Remote/Local control mode between Remote control and Local control.
RS RUN/STOP transfer key	Switching the RUN/STOP mode between RUN and STOP.

(7) Operation key

SET Set (SET) key	Used for parameter calling up and set value registration.
MODE Shift key	Shift digits when settings are changed. Used to selection operation between modes.
Down key	Decrease numerals.
Up key	Increase numerals.

(8) Infrared port
Used when sending and receiving data between this controller and the PDA installed with the RKCIR software.

To avoid damage to the instrument, never use a sharp object to press keys.

4. OPERATION FLOW OF EACH MODE

In order to make this instrument operable after being mounted on equipment and then wired, it needs to be set with operating conditions such as the set value (SV), input/output function, control function, etc. specific to each customer. In addition, the following operational flowchart illustrates key operation in each mode or each setting item. When actually setting these operating conditions specific to the customer, see the HA430/HA930 Operation Manual (IMR01N12-EC).

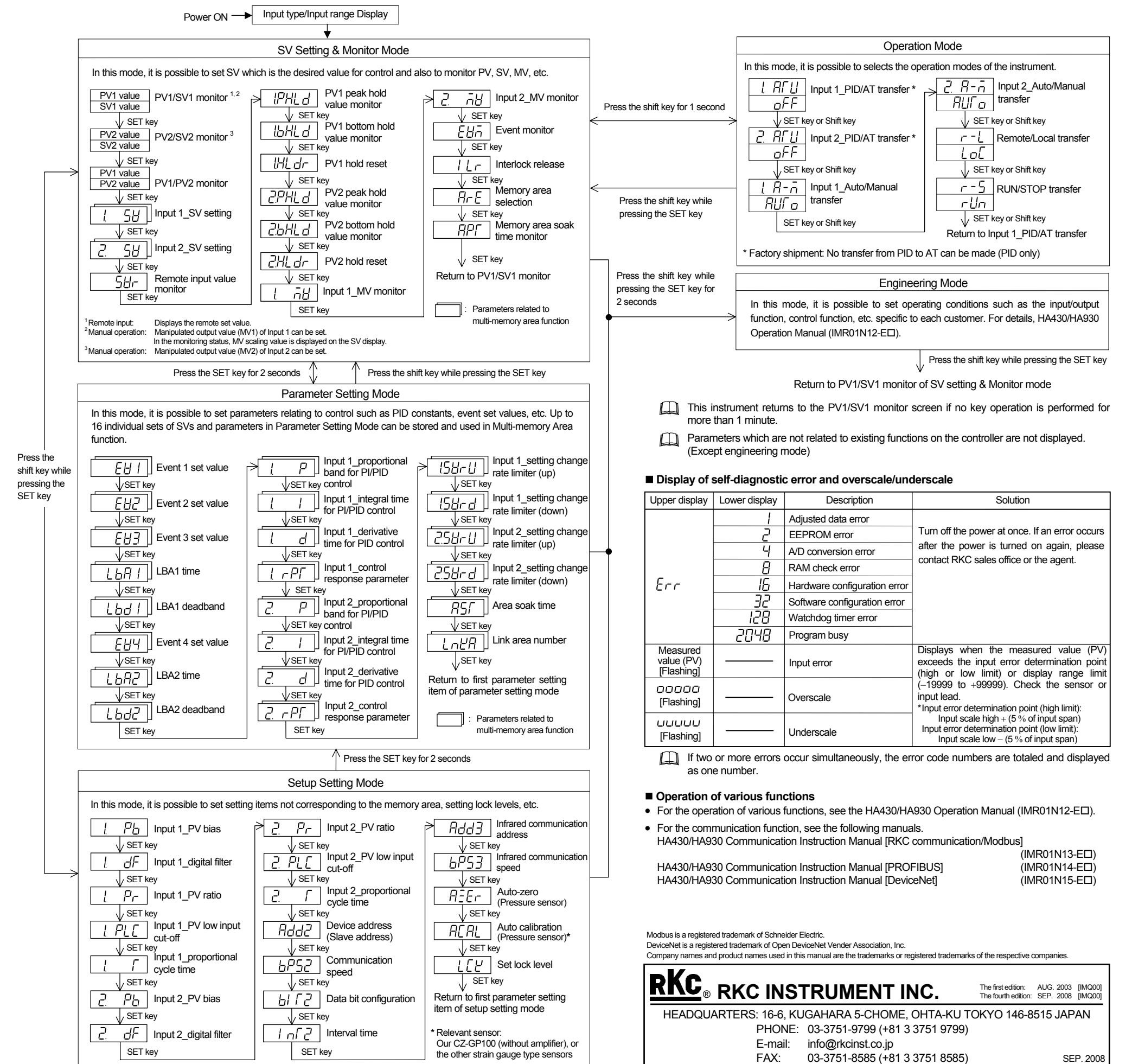

RKC RKC INSTRUMENT INC.

HEADQUARTERS: 16-6, KUGAHARA 5-CHOME, OHTA-KU TOKYO 146-8515 JAPAN
PHONE: 03-3751-9799 (+81 3 3751 9799)
E-mail: info@rkcinstr.co.jp
FAX: 03-3751-8585 (+81 3 3751 8585)

The first edition: AUG. 2003 [IM000]
The fourth edition: SEP. 2008 [IM000]

SEP. 2008